

## Product Data Sheet

**1. Flanged fittings**  
1.01 Flanged Bends  
**90° flanged bend (Q) PN10/16**

**Material** EN 1563 EN-GJS-400-15  
**Design Std.** EN 545  
**Coating** Epoxy GSK RAL-GZ 662  
**Approval** Kiwa BRL-K772/04



Kolk flanged fittings are made of ductile iron GJS-400/500 (DIN1693 GGG-40/50). Designed acc. to EN 545, flange drilling acc. to EN 1092-2 (ISO 7005-2). Epoxy coated (Resicoat®) acc. to EN 14901 (DIN 30677-2) and GSK certified (RAL-GZ 662).

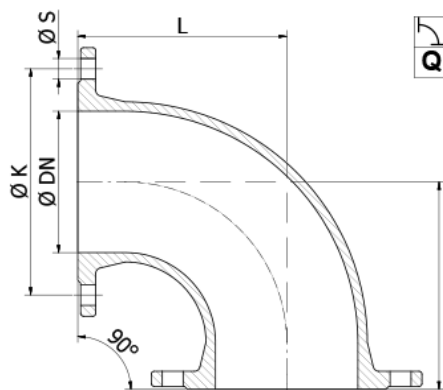

### 90° flanged bend (Q) PN10/16

Article	Article Nr.	PN	Ø DN [mm]	L [mm]	Holes # [DN]	Ø K [mm]	Ø S [mm]	G [kg]						
Q 50	1.02Q1.000010	PN10/16	50	150	4	125	19	7						
Q 65	1.02Q1.000020	PN10/16	65	165	4	145	19	8						
Q 80-4	1.02Q1.000030	PN10	80	165	4	160	19	9						
Q 80	1.02Q1.000031	PN10/16	80	165	8	160	19	9						
Q 100	1.02Q1.010010	PN10/16	100	180	8	180	19	12						
Q 125	1.02Q1.010020	PN10/16	125	200	8	210	19	16						
Q 150	1.02Q1.010030	PN10/16	150	220	8	240	23	20						
Q 200	1.02Q2.020010	PN10	200	260	8	295	23	30						
Q 250	1.02Q2.020020	PN10	250	350	12	350	23	50						
Q 300	1.02Q2.030010	PN10	300	400	12	400	23	70						
Q 350	1.02Q2.030020	PN10	350	450	16	460	23	90						
Q 400	1.02Q2.040010	PN10	400	500	16	515	28	116						
Q 450	1.02Q2.040020	PN10	450	550	20	565	28	190						
Q 500	1.02Q2.050010	PN10	500	600	20	620	28	185						
Q 600	1.02Q2.060010	PN10	600	700	20	725	31	276						
Q 700	1.02Q2.070010	PN10	700	800	24	840	31	395						
Q 800	1.02Q2.080010	PN10	800	900	24	950	34	542						
Q 900	1.02Q2.090010	PN10	900	1000	28	1050	34	710						
Q 1000	1.02Q2.100010	PN10	1000	1100	28	1160	37	920						
Q 1200	1.02Q2.120010	PN10	1200	1300	32	1380	41	1450						
Q 200	1.02Q3.020010	PN16	200	260	12	295	23	36						

### 90° flanged bend (Q) PN10/16

Article	Article Nr.	PN	∅ DN [mm]	L [mm]	Holes # [DN]	∅ K [mm]	∅ S [mm]	G [kg]						
Q 250	1.02Q3.020020	PN16	250	350	12	355	28	56						
Q 300	1.02Q3.030010	PN16	300	400	12	410	28	80						
Q 350	1.02Q3.030020	PN16	350	450	16	470	28	96						
Q 400	1.02Q3.040010	PN16	400	500	16	525	31	126						
Q 450	1.02Q3.040020	PN16	450	550	20	585	31	210						
Q 500	1.02Q3.050010	PN16	500	600	20	650	34	210						
Q 600	1.02Q3.060010	PN16	600	700	20	770	37	320						
Q 700	1.02Q3.070010	PN16	700	800	24	840	37	420						
Q 800	1.02Q3.080010	PN16	800	900	24	950	41	580						
Q 900	1.02Q3.090010	PN16	900	1000	28	1050	41	750						
Q 1000	1.02Q3.100010	PN16	1000	1100	28	1170	44	998						
Q 1200	1.02Q3.120010	PN16	1200	1300	32	1390	50	1550						

## **TRAN-SIG-MA**

**Tran-Sig-Ma spol. s r.o.**  
 Dukelských hrdinů 19  
 170 00 Praha 7 Czech Republic  
 Tel: 00420 233 373 040,  
 00420 233 370 903,  
 00420 233 380 185  
 E-mail: [info@tran-sig-ma.cz](mailto:info@tran-sig-ma.cz)  
<http://www.tran-sig-ma.cz>