

Product Data Sheet

2. Tyton fittings

2.03 Double socket bend Flange spigot

Double socket bend 90° (MMQ) PN10/16

Material EN 1563 EN-GJS-400-15

Design Std. EN 545

Coating Epoxy GSK RAL-GZ 662

Approval Kiwa BRL-K772/04



Kolk Tyton fittings are made of ductile iron GJS-400/500 (DIN1693 GGG-40/50). Design acc. to EN 545, flange drilling acc. to EN 1092-2 (ISO 7005-2). Epoxy coated (Resicoat®) acc. to EN 14901 (DIN 30677-2) and GSK certified (RAL-GZ 662).

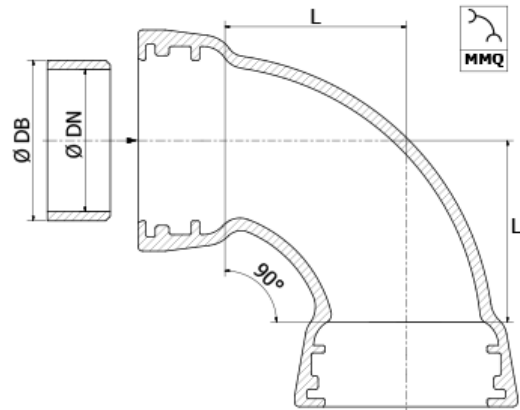

Double socket bend 90° (MMQ) PN10/16

Article	Article Nr.	PN	Ø DN [mm]	Ø DB [mm]	L [mm]	G [kg]									
MMQ 80	2.04MMQ1.000010	PN10/16	80	98	100	8									
MMQ 100	2.04MMQ1.010010	PN10/16	100	118	125	10									
MMQ 125	2.04MMQ1.010020	PN10/16	125	144	150	12									
MMQ 150	2.04MMQ1.010030	PN10/16	150	170	175	15									
MMQ 200	2.04MMQ1.020010	PN10/16	200	222	225	31									
MMQ 250	2.04MMQ1.020020	PN10/16	250	274	280	46									
MMQ 300	2.04MMQ1.030010	PN10/16	300	326	330	64									
MMQ 350	2.04MMQ1.030020	PN10/16	350	378	380	88									
MMQ 400	2.04MMQ1.040010	PN10/16	400	429	430	114									
MMQ 450	2.04MMQ1.040020	PN10/16	450	477	460	208									
MMQ 500	2.04MMQ1.050010	PN10/16	500	532	550	225									
MMQ 600	2.04MMQ1.060010	PN10/16	600	635	645	340									
MMQ 700	2.04MMQ1.070010	PN10/16	700	738	720	480									
MMQ 800	2.04MMQ1.080010	PN10/16	800	842	820	575									
MMQ 900	2.04MMQ1.090010	PN10/16	900	948	920	870									
MMQ 1000	2.04MMQ1.100010	PN10/16	1000	1048	1020	1060									
MMQ 1200	2.04MMQ1.120010	PN10/16	1200	1255	1220	1650									