

Product Data Sheet

1. Flanged fittings

1.07 All flanged cross

All flanged cross (TT) PN10/16

Material EN 1563 EN-GJS-400-15

Design Std. EN 545

Coating Epoxy GSK RAL-GZ 662

Approval Kiwa BRL-K772/04



Kolk flanged fittings are made of ductile iron GJS-400/500 (DIN1693 GGG-40/50). Designed acc. to EN 545, flange drilling acc. to EN 1092-2 (ISO 7005-2). Epoxy coated (Resicoat®) acc. to EN 14901 (DIN 30677-2) and GSK certified (RAL-GZ 662). The table contains only the standard lengths. Non standard lengths are possible.

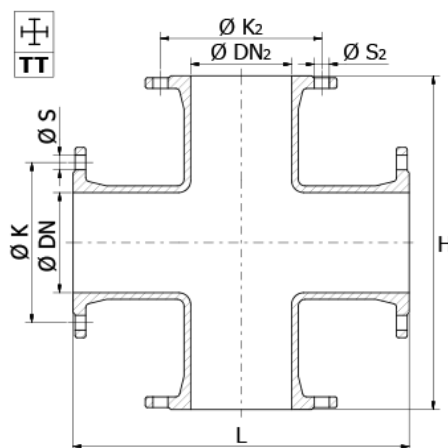

All flanged cross (TT) PN10/16

Article	Article Nr.	PN	ø DN [mm]	ø DN2 [mm]	L [mm]	H [mm]	Holes # [DN]	ø K [mm]	ø S [mm]	Holes # [DN2]	ø K2 [mm]	ø S2 [mm]	G [kg]
TT 50/50	1.07TT1.000010	PN10/16	50	50	300	300	4	125	19	4	125	19	15
TT 80/80	1.07TT1.000020	PN10/16	80	80	330	330	8	160	19	8	160	19	20
TT 100/100	1.07TT1.010010	PN10/16	100	100	360	360	8	180	19	8	180	19	26
TT 125/125	1.07TT1.010020	PN10/16	125	125	400	400	8	210	19	8	210	19	34
TT 150/150	1.07TT1.010030	PN10/16	150	150	440	440	8	240	23	8	240	23	40
TT 200/200	1.07TT2.020010	PN10	200	200	520	520	8	295	23	8	295	23	60
TT 250/250	1.07TT2.020020	PN10	250	250	700	700	12	350	23	12	350	23	104
TT 300/300	1.07TT2.030010	PN10	300	300	800	800	12	400	23	12	400	23	136
TT 350/350	1.07TT2.030020	PN10	350	350	850	850	16	460	23	16	460	23	180
TT 400/400	1.07TT2.040010	PN10	400	400	900	900	16	515	28	16	515	28	220
TT 450/450	1.07TT2.040020	PN10	450	450	950	950	20	565	28	20	565	28	310
TT 500/500	1.07TT2.050010	PN10	500	500	1000	1000	20	620	28	20	620	28	380
TT 600/600	1.07TT2.060010	PN10	600	600	1100	1100	20	725	31	20	725	31	530
TT 700/700	1.07TT2.070010	PN10	700	700	1200	1200	24	840	31	24	840	31	660
TT 800/800	1.07TT2.080010	PN10	800	800	1350	1350	24	950	34	24	950	34	980
TT 900/900	1.07TT2.090010	PN10	900	900	1500	1500	28	1050	34	28	1050	34	1200
TT 1000/1000	1.07TT2.100010	PN10	1000	1000	1650	1650	28	1160	37	28	1160	37	1450
TT 200/200	1.07TT3.020010	PN16	200	200	520	520	12	295	23	12	295	23	60
TT 250/250	1.07TT3.020020	PN16	250	250	700	700	12	355	28	12	355	28	104
TT 300/300	1.07TT3.030010	PN16	300	300	800	800	12	410	28	12	410	28	136
TT 350/350	1.07TT3.030020	PN16	350	350	850	850	16	470	28	16	470	28	180

All flanged cross (TT) PN10/16

Article	Article Nr.	PN	∅ DN [mm]	∅ DN2 [mm]	L [mm]	H [mm]	Holes # [DN]	∅ K [mm]	∅ S [mm]	Holes # [DN2]	∅ K2 [mm]	∅ S2 [mm]	G [kg]
TT 400/400	1.07TT3.040010	PN16	400	400	900	900	16	525	31	16	525	31	250
TT 450/450	1.07TT3.040020	PN16	450	450	950	950	20	585	31	20	585	31	345
TT 500/500	1.07TT3.050010	PN16	500	500	1000	1000	20	650	34	20	650	34	430
TT 600/600	1.07TT3.060010	PN16	600	600	1100	1100	20	770	37	20	770	37	550
TT 700/700	1.07TT3.070010	PN16	700	700	1200	1200	24	840	37	24	840	37	690
TT 800/800	1.07TT3.080010	PN16	800	800	1350	1350	24	950	41	24	950	41	1020
TT 900/900	1.07TT3.090010	PN16	900	900	1500	1500	28	1050	41	28	1050	41	1250
TT 1000/1000	1.07TT3.100010	PN16	1000	1000	1650	1650	28	1170	44	28	1170	44	1500

 **TRAN-SIG-MA**

Tran-Sig-Ma spol. s r.o.
 Dukelských hrdinů 19
 170 00 Praha 7 Czech
 Republic

Tel: 00420 233 373 040,
 00420 233 370 903,
 00420 233 380 185
 E-mail: info@tran-sig-ma.cz
<http://www.tran-sig-ma.cz>