

Product Data Sheet

1. Flanged fittings

1.01 Flanged Bends

22½° flanged bend (FFK 22½°) PN10/16

Material EN 1563 EN-GJS-400-15

Design Std. EN 545

Coating Epoxy GSK RAL-GZ 662

Approval Kiwa BRL-K772/04



RAL GÜTEZEICHEN
Zertifiziert nach EN 1092-2
für Flansche und Flanschen



Kolk flanged fittings are made of ductile iron GJS-400/500 (DIN1693 GGG-40/50). Designed acc. to EN 545, flange drilling acc. to EN 1092-2 (ISO 7005-2). Epoxy coated (Resicoat®) acc. to EN 14901 (DIN 30677-2) and GSK certified (RAL-GZ 662).

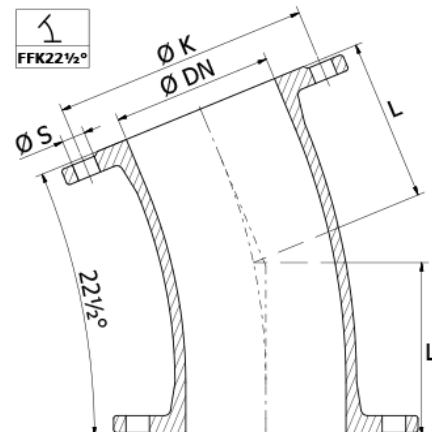

22½° flanged bend (FFK 22½°) PN10/16

Article	Article Nr.	PN	ø DN [mm]	L [mm]	Holes # [DN]	ø K [mm]	ø S [mm]	G [kg]						
FFK 50/22½°	1.02FFK1.000013	PN10/16	50	50	4	125	19	9						
FFK 65/22½°	1.02FFK1.000023	PN10/16	65	65	4	145	19	10						
FFK 80/22½°	1.02FFK1.000033	PN10/16	80	80	8	160	19	10						
FFK 100/22½°	1.02FFK1.010013	PN10/16	100	100	8	180	19	12						
FFK 125/22½°	1.02FFK1.010023	PN10/16	125	125	8	210	19	16						
FFK 150/22½°	1.02FFK1.010033	PN10/16	150	150	8	240	23	19						
FFK 200/22½°	1.02FFK2.020013	PN10	200	200	8	295	23	29						
FFK 250/22½°	1.02FFK2.020023	PN10	250	250	12	350	23	42						
FFK 300/22½°	1.02FFK2.030013	PN10	300	300	12	400	23	60						
FFK 350/22½°	1.02FFK2.030023	PN10	350	350	16	460	23	65						
FFK 400/22½°	1.02FFK2.040013	PN10	400	400	16	515	28	70						
FFK 450/22½°	1.02FFK2.040023	PN10	450	450	20	565	28	90						
FFK 500/22½°	1.02FFK2.050013	PN10	500	500	20	620	28	100						
FFK 600/22½°	1.02FFK2.060013	PN10	600	600	20	725	31	180						
FFK 700/22½°	1.02FFK2.070013	PN10	700	700	24	840	31	310						
FFK 800/22½°	1.02FFK2.080013	PN10	800	800	24	950	34	420						
FFK 900/22½°	1.02FFK2.090013	PN10	900	900	28	1050	34	442						
FFK 1000/22½°	1.02FFK2.100013	PN10	1000	1000	28	1160	37	586						
FFK 1200/22½°	1.02FFK2.120013	PN10	1200	1200	32	1380	41	905						
FFK 200/22½°	1.02FFK3.020013	PN16	200	200	12	295	23	29						
FFK 250/22½°	1.02FFK3.020023	PN16	250	250	12	355	28	42						

22½° flanged bend (FFK 22½°) PN10/16

Article	Article Nr.	PN	∅ DN [mm]	L [mm]	Holes # [DN]	∅ K [mm]	∅ S [mm]	G [kg]						
FFK 300/22½°	1.02FFK3.030013	PN16	300	300	12	410	28	60						
FFK 350/22½°	1.02FFK3.030023	PN16	350	350	16	470	28	70						
FFK 400/22½°	1.02FFK3.040013	PN16	400	400	16	525	31	82						
FFK 450/22½°	1.02FFK3.040023	PN16	450	450	20	585	31	106						
FFK 500/22½°	1.02FFK3.050013	PN16	500	500	20	650	34	125						
FFK 600/22½°	1.02FFK3.060013	PN16	600	600	20	770	37	220						
FFK 700/22½°	1.02FFK3.070013	PN16	700	700	24	840	37	340						
FFK 800/22½°	1.02FFK3.080013	PN16	800	800	24	950	41	640						
FFK 900/22½°	1.02FFK3.090013	PN16	900	900	28	1050	41	440						
FFK 1000/22½°	1.02FFK3.100013	PN16	1000	1000	28	1170	44	590						
FFK 1200/22½°	1.02FFK3.120013	PN16	1200	1200	32	1390	50	1150						

TRAN-SIG-MA

Tran-Sig-Ma spol. s r.o.
 Dukelských hrdinů 19
 170 00 Praha 7 Czech Republic
 Tel: 00420 233 373 040,
 00420 233 370 903,
 00420 233 380 185
 E-mail: info@tran-sig-ma.cz
<http://www.tran-sig-ma.cz>