

Product Data Sheet

2. Tyton fittings

2.01 Flange socket

Flange-socket (EU) PN10/16

Material EN 1563 EN-GJS-400-15

Design Std. EN 545

Coating Epoxy GSK RAL-GZ 662

Approval Kiwa BRL-K772/04



Kolk Tyton fittings are made of ductile iron GJS-400/500 (DIN1693 GGG-40/50). Design acc. to EN 545, flange drilling acc. to EN 1092-2 (ISO 7005-2). Epoxy coated (Resicoat®) acc. to EN 14901 (DIN 30677-2) and GSK certified (RAL-GZ 662).

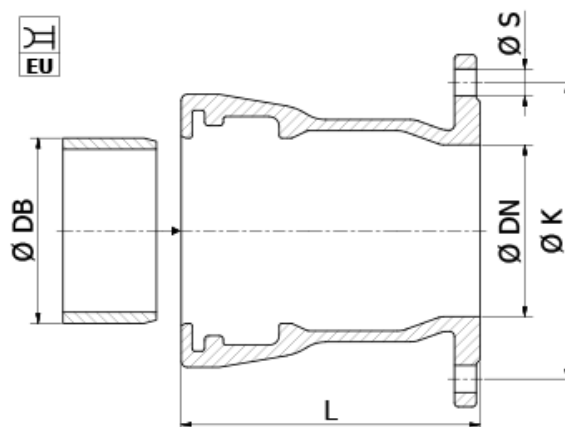

Flange-socket (EU) PN10/16

Article	Article Nr.	PN	Ø DN [mm]	Ø DB [mm]	L [mm]	Holes # [DN]	Ø K [mm]	Ø S [mm]	G [kg]					
EU 80	2.01EU1.000010	PN10/16	80	98	130	8	160	19	8					
EU 100	2.01EU1.010010	PN10/16	100	118	130	8	180	19	10					
EU 125	2.01EU1.010020	PN10/16	125	144	135	8	210	19	12					
EU 150	2.01EU1.010030	PN10/16	150	170	135	8	240	23	15					
EU 200	2.01EU2.020010	PN10	200	222	140	8	295	23	20					
EU 250	2.01EU2.020020	PN10	250	274	145	12	350	23	30					
EU 300	2.01EU2.030010	PN10	300	326	150	12	400	23	36					
EU 350	2.01EU2.030020	PN10	350	378	155	16	460	23	43					
EU 400	2.01EU2.040010	PN10	400	429	160	16	515	28	52					
EU 450	2.01EU2.040020	PN10	450	477	165	20	565	28	65					
EU 500	2.01EU2.050010	PN10	500	532	170	20	620	28	90					
EU 600	2.01EU2.060010	PN10	600	635	180	20	725	31	125					
EU 700	2.01EU2.070010	PN10	700	738	190	24	840	31	180					
EU 800	2.01EU2.080010	PN10	800	842	200	24	950	34	230					
EU 900	2.01EU2.090010	PN10	900	945	210	28	1050	34	305					
EU 1000	2.01EU2.100010	PN10	1000	1048	220	28	1160	37	290					
EU 1200	2.01EU2.120010	PN10	1200	1255	240	32	1380	41	620					
EU 200	2.01EU3.020010	PN16	200	222	140	12	295	23	20					
EU 250	2.01EU3.020020	PN16	250	274	145	12	355	28	30					
EU 300	2.01EU3.030010	PN16	300	326	150	12	410	28	36					
EU 350	2.01EU3.030020	PN16	350	378	155	16	470	28	43					

Flange-socket (EU) PN10/16

Article	Article Nr.	PN	ø DN [mm]	ø DB [mm]	L [mm]	Holes # [DN]	ø K [mm]	ø S [mm]	G [kg]					
EU 400	2.01EU3.040010	PN16	400	429	160	16	525	31	52					
EU 450	2.01EU3.040020	PN16	450	477	165	20	585	31	65					
EU 500	2.01EU3.050010	PN16	500	532	170	20	650	34	90					
EU 600	2.01EU3.060010	PN16	600	635	180	20	770	37	125					
EU 700	2.01EU3.070010	PN16	700	738	190	24	840	37	180					
EU 800	2.01EU3.080010	PN16	800	842	200	24	950	41	230					
EU 900	2.01EU3.090010	PN16	900	945	210	28	1050	41	305					
EU 1000	2.01EU3.100010	PN16	1000	1048	220	28	1170	44	290					
EU 1200	2.01EU3.120010	PN16	1200	1255	240	32	1390	50	620					

 **TRAN-SIG-MA**

Tran-Sig-Ma spol. s r.o.
 Dukelských hrdinů 19
 170 00 Praha 7 Czech
 Republic

Tel: 00420 233 373 040,
 00420 233 370 903,
 00420 233 380 185
 E-mail: info@tran-sig-ma.cz
<http://www.tran-sig-ma.cz>